



## 49 Greencroft Street, Salisbury, Wiltshire, SP1 1JF

\*\*\* VIEWINGS ON HOLD DUE TO HIGH DEMAND \*\*\*

A nicely presented 4 bed, 3 storey Victorian townhouse with an attractive garden, available on a long-term basis.

- Victorian Town House
- Three Storey
- Four Bedrooms
- Two Reception Rooms
- Sunny Rear Garden
- Gas Heating
- Long Term Tenancy
- Unfurnished
- Shower Room and Ground Floor WC
- Close to Park

**£1,450 PCM**

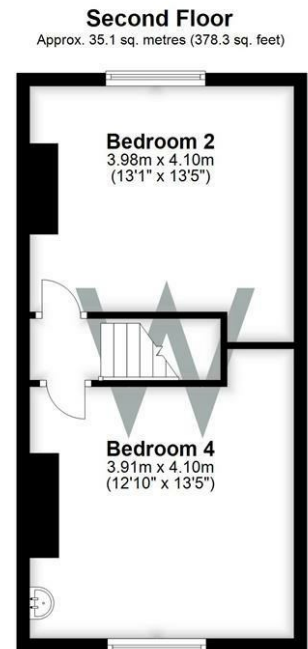
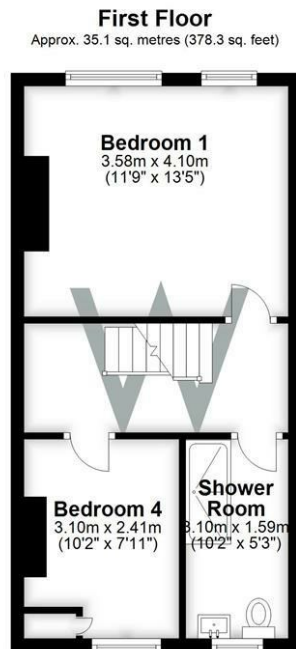
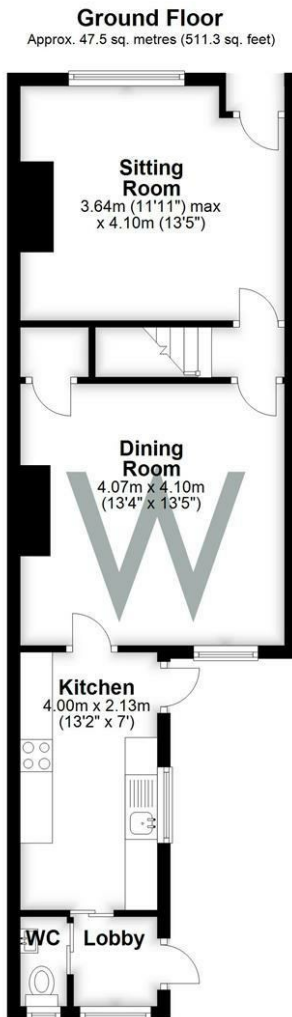

## WHITES

Castle Chambers, 47 Castle Street, Salisbury,  
Wiltshire, SP1 3SP

Tel: 01722 336422/Option 2

[www.hwwhite.co.uk](http://www.hwwhite.co.uk)

email: [lettings-management@hwwhites.co.uk](mailto:lettings-management@hwwhites.co.uk)

Energy Efficiency Rating		
	Current	Potential
Very energy efficient - lower running costs		
(92 plus) <b>A</b>		<b>83</b>
(81-91) <b>B</b>		
(69-80) <b>C</b>		
(55-68) <b>D</b>		
(39-54) <b>E</b>		<b>56</b>
(21-38) <b>F</b>		
(1-20) <b>G</b>		
Not energy efficient - higher running costs		
England & Wales		
EU Directive 2002/91/EC		

Environmental Impact (CO <sub>2</sub> ) Rating		
	Current	Potential
Very environmentally friendly - lower CO <sub>2</sub> emissions		
(92 plus) <b>A</b>		
(81-91) <b>B</b>		
(69-80) <b>C</b>		
(55-68) <b>D</b>		
(39-54) <b>E</b>		
(21-38) <b>F</b>		
(1-20) <b>G</b>		
Not environmentally friendly - higher CO <sub>2</sub> emissions		
England & Wales		
EU Directive 2002/91/EC		